

YPSILANTI - FREESTANDING RETAIL/CANNABIS BUILDING

401 EAST MICHIGAN AVENUE | YPSILANTI, MI 48198



FOR SALE | FOR LEASE

C3 CRE, LLC | 36800 Woodward Avenue | Suite 301 | Bloomfield Hills, MI 48304 | 248.220.1110 | c3cre.com



YPSILANTI - FREESTANDING RETAIL/CANNABIS BUILDING

401 EAST MICHIGAN AVENUE | YPSILANTI, MI 48198

PROPERTY HIGHLIGHTS

- Municipal Green Zone property for an Adult-Use Provisioning Center available for sale – real estate included in the sale.
- Buyer will need to purchase their own Adult-Use Provisioning Center license separately and obtain Site Plan/Special Land Use approvals to operate here.
- An operator has the option to lease the real estate on an Absolute NNN Lease with ownership providing a build-to-suit construction model or tenant incentives.
- Suitable for traditional retail and restaurant purposes, no need to buy solely for licensed cannabis use.
- Situated in a near prime Downtown Ypsilanti location offering maximum exposure, near Eastern Michigan University, Washtenaw Community College, and IHA Trinity Health.
- Located near a walkable neighborhood near local and national retailers that are staples in the community, and surrounded by a dense residential population.

DEMOGRAPHICS	1 MILE	3 MILES	5 MILES
Total Households	6,152	28,644	50,776
Total Population	12,027	67,053	120,606
Average HH Income	\$64,346	\$77,879	\$93,878

BUILDING SIZE

1,370 SF (Plus a Full Basement)

LAND SIZE

0.30 Acres

ASKING PRICE

\$299,999 (Seller Financing Available)

LEASE PRICE

Contact Broker

AREA TENANTS



YPSILANTI - FREESTANDING RETAIL/CANNABIS BUILDING

401 EAST MICHIGAN AVENUE | YPSILANTI, MI 48198

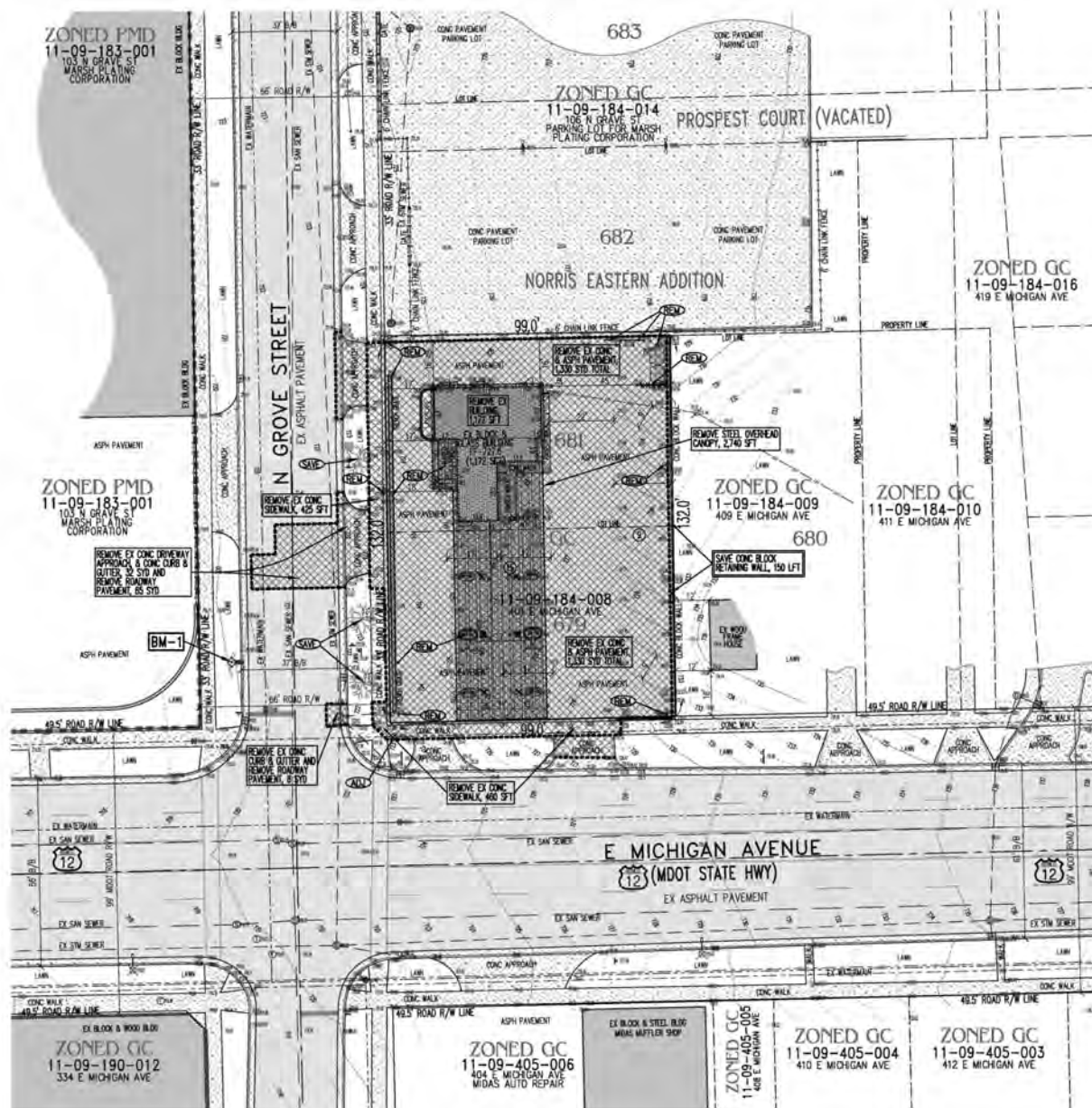

YPSILANTI - FREESTANDING RETAIL/CANNABIS BUILDING

401 EAST MICHIGAN AVENUE | YPSILANTI, MI 48198



YPSILANTI - FREESTANDING RETAIL/CANNABIS BUILDING

401 EAST MICHIGAN AVENUE | YPSILANTI, MI 48198



YPSILANTI - FREESTANDING RETAIL/CANNABIS BUILDING

401 EAST MICHIGAN AVENUE | YPSILANTI, MI 48198

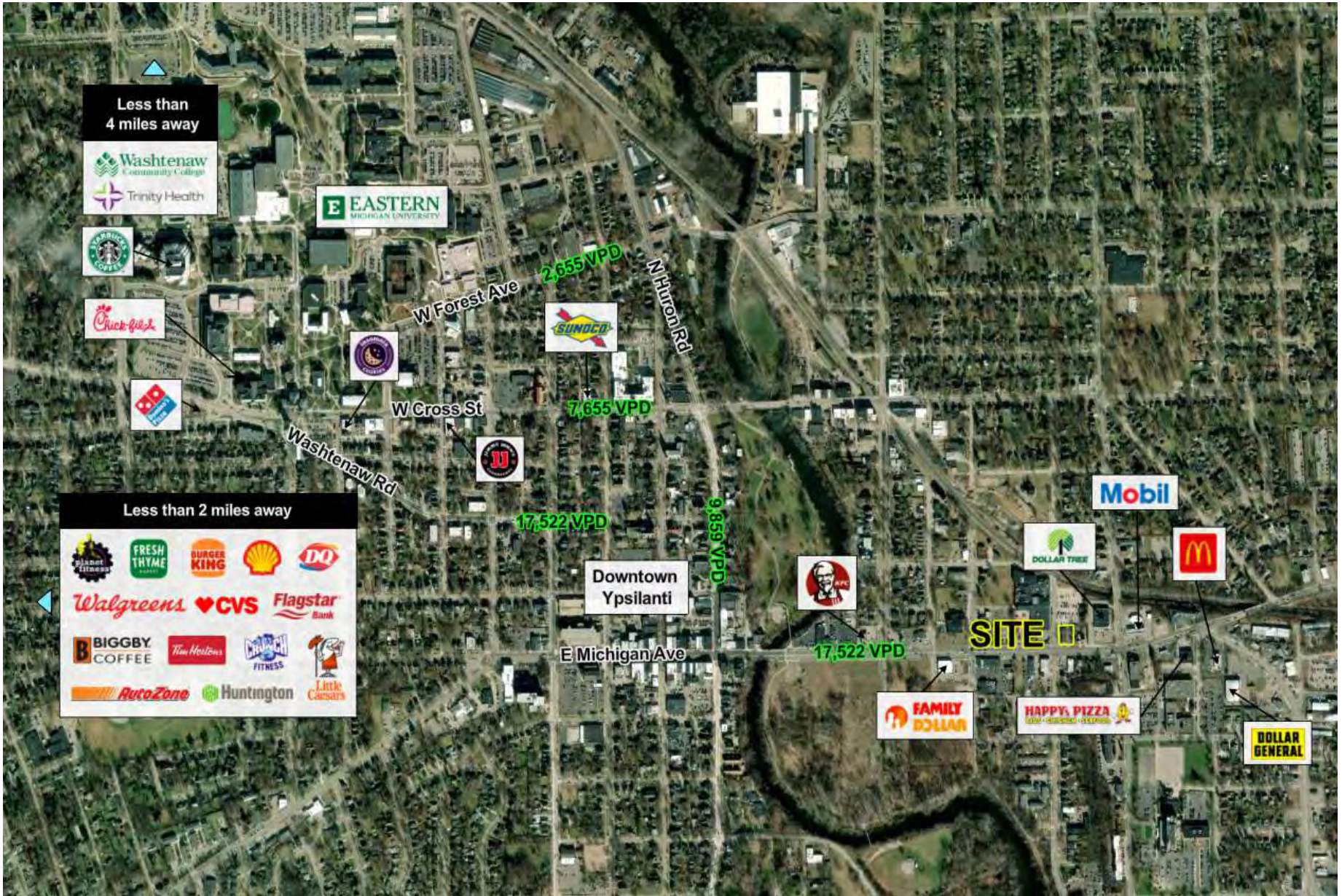



CORBIN YALDOO

Founder/President
248.220.1110 x01
corbin@c3cre.com



CHARLES AL-SHEIKH

Sales Associate
248.220.1110 x02
charlie@c3cre.com

SERVICES

Buyer and Seller Representation
Land Brokerage

Cannabis Acquisitions and Dispositions
Portfolio and Surplus Property Sales

Investment Sales
Site Selection and Location Strategy



YPSILANTI - FREESTANDING RETAIL/CANNABIS BUILDING

401 EAST MICHIGAN AVENUE | YPSILANTI, MI 48198

General:

C3 CRE, LLC is a licensed real estate brokerage, and our employees and contractors are not a substitute for qualified legal, tax or accounting advice. We do not provide such advice. We recommend obtaining the advice of qualified legal counsel and other professionals. Any assistance we may provide in reviewing legal documents is for guidance as a courtesy only. Our agents have no authority to contractually bind any client.

All property information is subject to the possibility of errors, omissions, change of price or other terms or conditions, prior sale, lease or financing, and withdrawal without notice. Delays, omissions and inaccuracies may arise due to a number of factors, including changes in laws.

We obtain information from sources we believe are reliable, but we provide no guaranty or warranty concerning its accuracy. Any projections, estimates, future plans, and forward-looking statements are based on assumptions, subject to uncertainty, and may vary from actual results. All information should be independently verified.

Affiliations:

We may have relationships with companies we recommend or with whom we conduct business, including lenders, real estate brokers, loan brokers, insurance agents and others. We never require use of any company as a condition of our services. You should review each provider's fees, rates, terms of service and other relevant information.

Cannabis Industry Regulation:

Our services to those in the cannabis industry are limited by state laws relating to medical and adult use cannabis operations. All cannabis-related business is currently illegal under U.S. federal law. Nothing contained on our website or other marketing materials nor any of our services is intended to assist in any violation of law. Our cannabis-related marketing materials are intended for use in jurisdictions in which cannabis is legal. Both Michigan law and municipal ordinances have licensing and permitting requirements and processes for cannabis-related businesses. You should consult an attorney or other knowledgeable professional on such matters.

Real Estate Agency Relationships:

Seller's/Owner's Agent - A seller's/owner's agent, under a listing agreement with the seller/owner, acts solely on behalf of the seller/owner. A seller/owner can authorize a seller's/owner's agent to work with subagents, buyer's/tenant's agents and/or transaction coordinators. A subagent is one who has agreed to work with the listing agent, and who, like the listing agent, acts solely on behalf of the seller/owner. Seller's/Owner's agents and subagents will disclose to the seller/owner known information about the buyer/tenant which may be used to the benefit of the seller/owner. Individual services may be waived by the seller/owner through execution of a limited-service agreement.

Buyer's/Tenant's Agent - A buyer's/tenant's agent, under a buyer's/tenant's agency agreement with the buyer/tenant, acts solely on behalf of the buyer/tenant. Buyer's/Tenant's agents and subagents will disclose to the buyer/tenant known information about the seller/owner which may be used to benefit the buyer/tenant. Individual services may be waived by the buyer/tenant through execution of a limited-service agreement.

Dual Agents - A real estate licensee can be the agent of both the seller/owner and buyer/tenant in a transaction, but only with the knowledge and informed consent, in writing, of both the seller/owner and the buyer/tenant. In such a dual agency situation, the agent will not be able to disclose all known information to either the seller/owner or the buyer/tenant. The obligations of a dual agent are subject to any specific provisions set forth in any agreement between the dual agent, the seller/owner, and the buyer/tenant.